



AMOSKEAG HEALTH

88 McGregor Street, Suite 302
Medical Office Building
adjacent to Catholic Medical Center (CMC) hospital

Starting from: **Parking Garage**

1) From the Parking Garage, follow signs for Sky Bridge. Take elevator to third floor for Sky Bridge.



2) Walk over the Sky Bridge. At the end of the Sky Bridge, you will see this elevator. Take the elevator down to Floor A.



3) Take a left out of the elevator and then go through the door on the left. **DO NOT** follow the sign that says "Hospital Main Lobby."



4) Follow the hallway until you arrive at the elevator with the maroon doors. Take this elevator to the third floor.

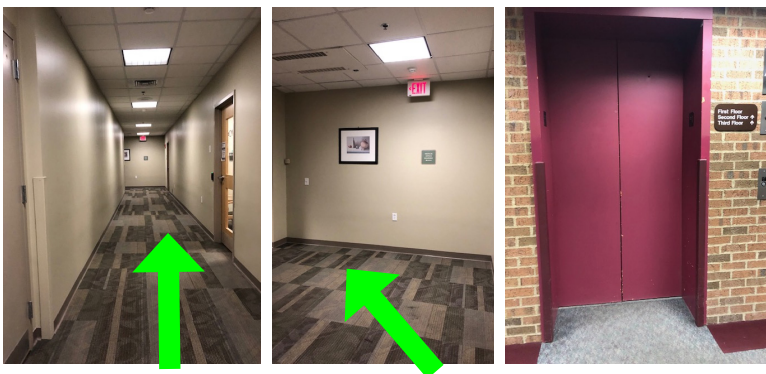

5) Exit the elevator on the third floor and go to first door on the right, Suite 302.



Starting from: **Putnam Street Parking Lot**

1.) Enter through the two sets of double doors and then take elevator to third floor.

2.) Exit elevator on third floor and go to the first door on the right, Suite 302.



Starting from: **Ground floor below Sky Bridge**
**Wheelchair Accessible*

1.) Enter the double doors under Skybridge

2.) Go through the door on the left. **DO NOT** follow the sign that says "Hospital Main Lobby."

3.) Follow the hallway until you arrive at the elevator. Take elevator to third floor.

4.) Exit elevator on third floor and go to first door on the right, Suite 302.



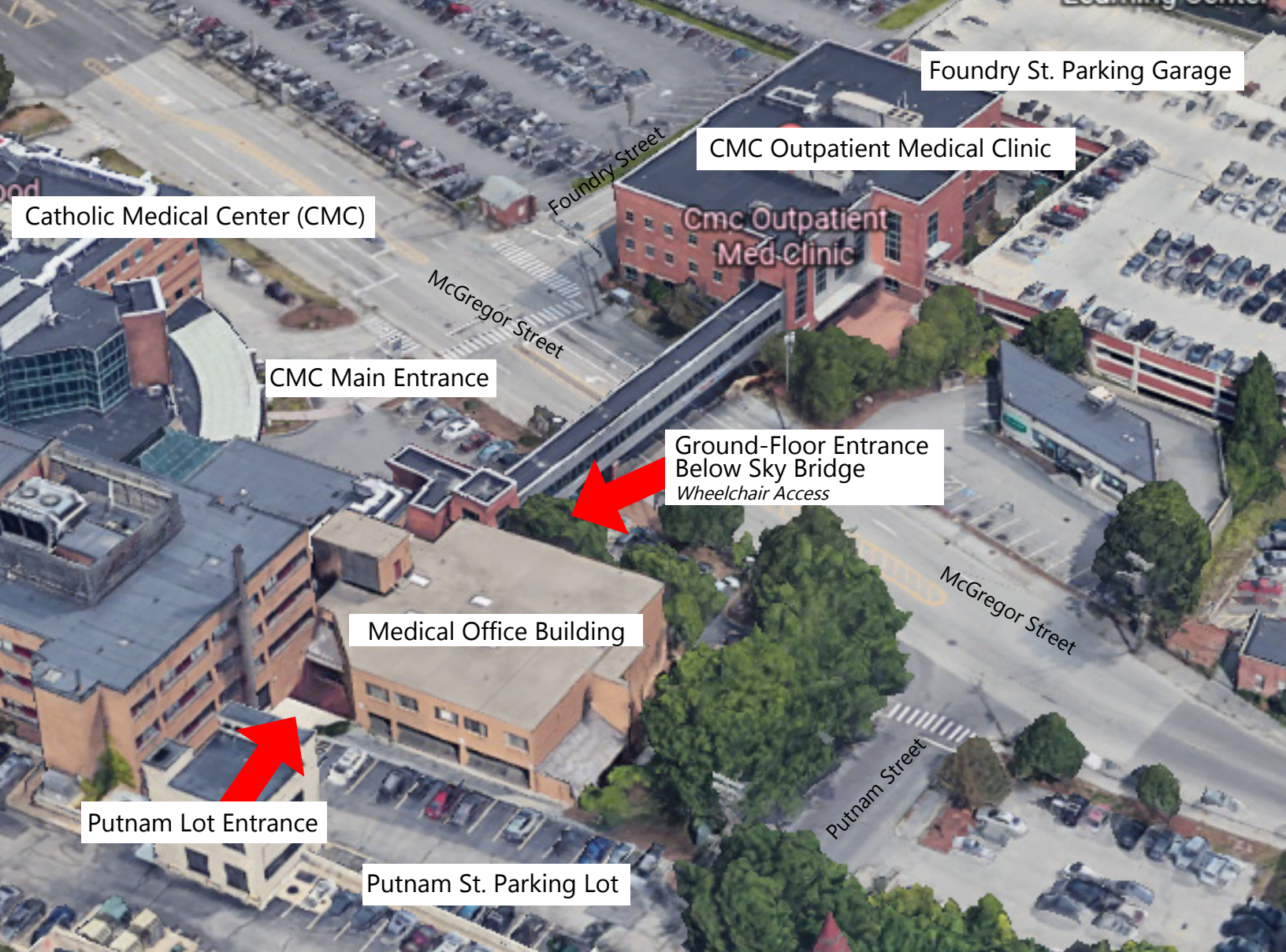

**88 McGregor Street, Suite 302,
Medical Office Building**
adjacent to Catholic Medical Center (CMC) hospital

Parking Options for Amoskeag Health patients at 88 McGregor Street:

1. Putnam Street Parking Lot (limited)
2. Free Parking Garage on Foundry Street
3. Free Overflow Parking Lot with Shuttle to Main Entrance of CMC
4. Main Entrance of CMC for Free Valet Service



**If you have questions about
directions or parking,
please call 603-626-9500.**